

INDUSTRIAL/WAREHOUSE
FOR LEASE

Guilds Lake Industrial Park

4322 NW Yeon Avenue, Portland, OR 97210
Building 1



Key Features



26,113 sq. ft. shell



4,291 sq. ft. office



7 dock doors
1 leveler
1 oversized grade door

20' clear height

Excellent exposure with
Yeon Ave frontage

LED lighting

Mezzanine storage

Prominent industrial hub
with easy access to I-405,
I-5 and Port of Portland

Lease Rate (NNN):

\$0.85/sq. ft. shell

\$1.10/sq. ft. office

Jake Bigby

jakeb@pactrust.com

Caitlin Knecht

caitlink@pactrust.com

503.624.6300

Owned & Managed by

PACTRUST

Space Plan

4322 NW Yeon Avenue, Portland, OR 97210

26,113 Sq. Ft.

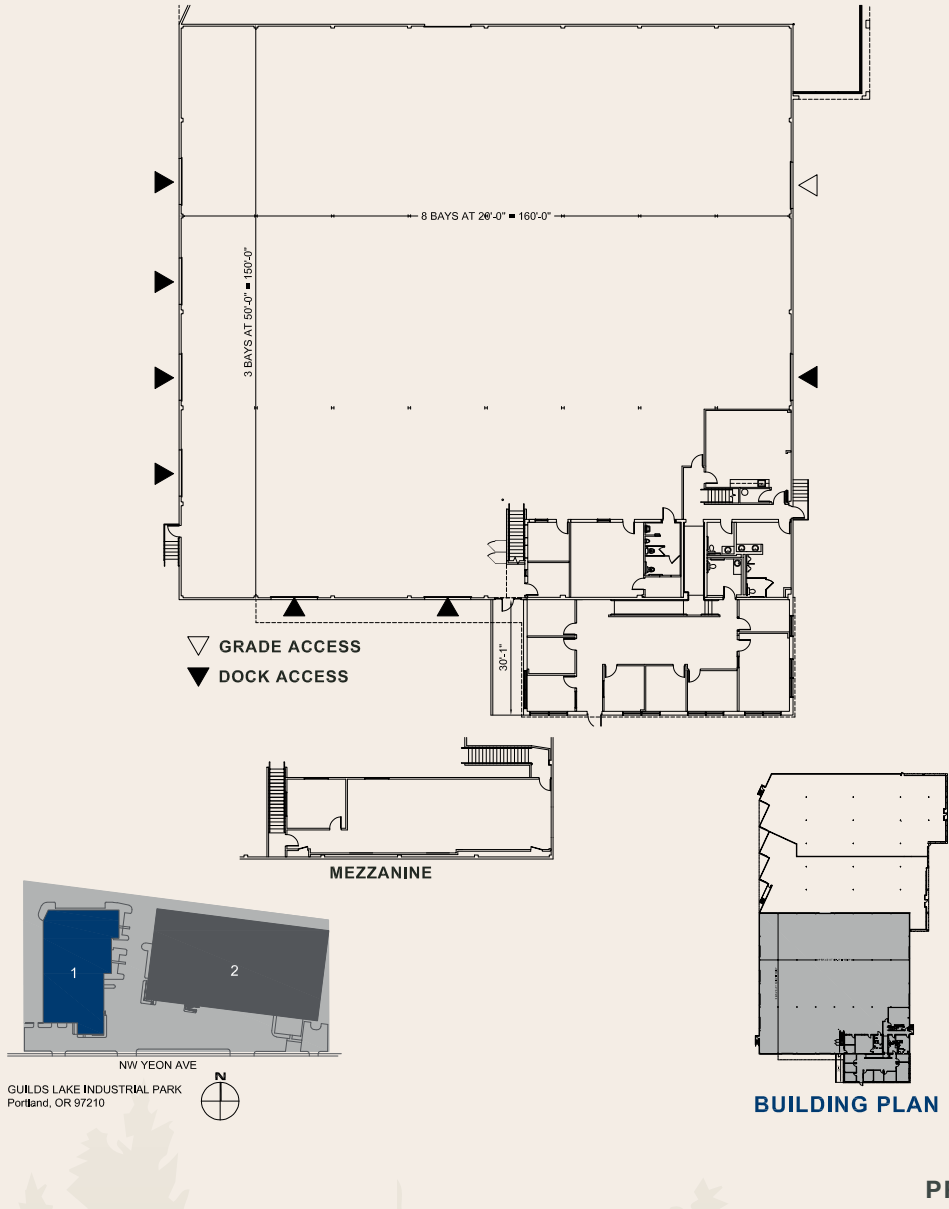

Jake Bigby
jakeb@pactrust.com

Caitlin Knecht
caitlink@pactrust.com

503.624.6300
www.PacTrust.com